

**NVH220  
LOPHIUS AI**

Barcode Programming V1.0

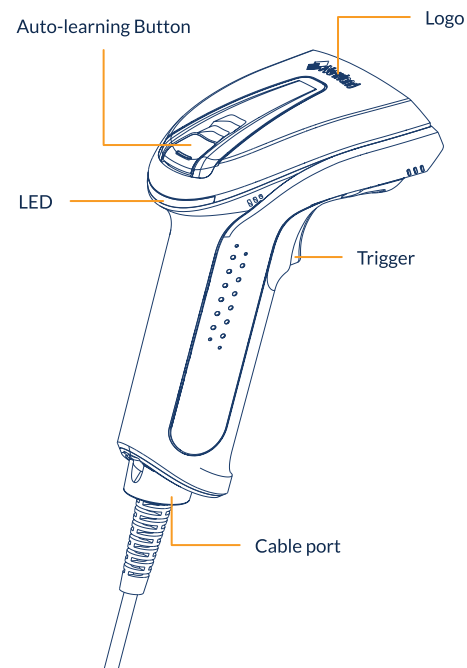

1

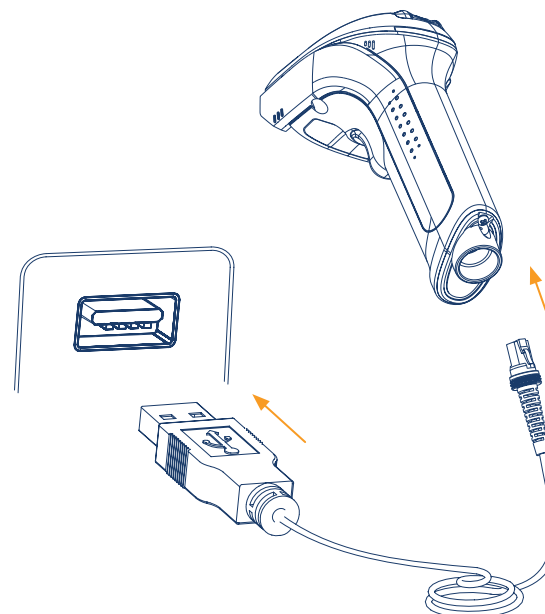

- 1 Plug the RJ50 connector into data port on the scanner.
- 2 Plug the USB connector into the USB port on the host.

2

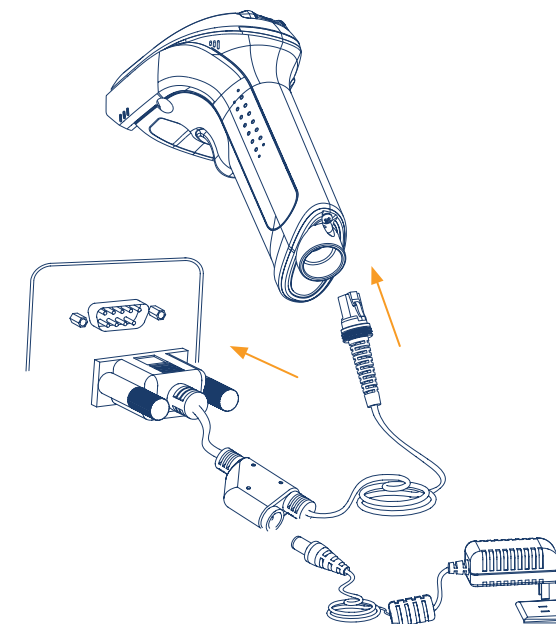

Note: The host refers to PC, POS or other terminal equipped with USB,RS232 interface.

3

Connect communication cable

Auto-learning

CE / WEEE

FCC / More information

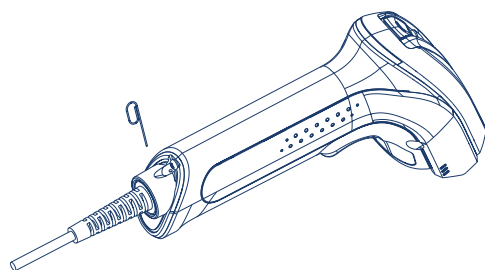

Get an appropriate needle or straightened paperclip and then follow the steps below:

- 1 Insert the needle into the dismantling hole;
- 2 Pull out the cable slowly from the scanner while applying pressure on the needle;
- 3 Remove the needle;
- 4 Pull out the cable from the host.

4

The auto-learning function can automatically adjust the image brightness and enable the symbology to optimize the decoding performance. The operating steps are as follows:

- 1 Please long-press the auto-learning button on the top of the scanner for three seconds to activate this function.
- 2 Hold the scanner still and the light will automatically flash to adjust the illumination.
- 3 The green LED on the top of the scanner and the good read beep indicate a successful operation. The red LED on the top of the scanner and the bad read beep indicate a failed operation.
- 4 The configuration of auto-learning can be saved manually in the Nset for further decoding of the same type of barcode.

Troubleshooting

- 1 Ensure that the data cable is securely connected.
- 2 Check the scan window and clean it in a timely manner.
- 3 Ensure that the type of barcode symbology is enabled.
- 4 If you are unable to solve the issues on your own, please reach out to your dealer or contact Newland's customer service center for assistance.

5



Marking and European Economic Area (EEA)

Statement of Compliance

We hereby declare that this device is in compliance with the essential requirements and other relevant provisions of Directive 2014/53/EU.

The ventilation should not be impeded by covering the ventilation openings with items, such as newspapers, tablecloths, curtains, etc.;

This product max operating ambient temperature is 60 degrees C.

⎓ Direct Current Symbol



Recycling

This product bears the selective sorting symbol for waste electrical and electronic equipment (WEEE). This means that this product must be handled pursuant to European directive 2012/19/EU in order to be recycled or dismantled to minimize its impact on the environment.

6

Radio frequency interference requirements

Radio transmitters (part 15)

This device complies with part 15 of the FCC Rules.

Operation is subject to the following two conditions:

- 1 This device may not cause harmful interference, and
- 2 This device must accept any interference received, including interference that may cause undesired operation.



Visit our website  
newland-id.com

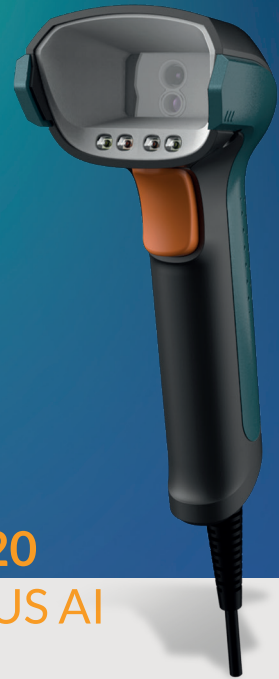

**NVH220  
LOPHIUS AI**

Barcode Programming

1 Scanner information



@QRYSYS  
Query all information

2 Defaults settings



@FACDEF  
Restore all factory defaults

1

3 Scanning mode



@SCNMOD0  
Level mode



@SCNMOD3  
Continuous mode



@SCNMOD5  
Aiming mode



@SCNMOD7  
Batch mode

2

4 Interface settings



@INTERF3  
USB HID Keyboard



@INTERF8  
USB COM port emulation



@INTERFO  
RS-232

3

5 Illumination color



@ILLCLR0  
Red LED



@ILLCLR1  
White LED



@ILLCLR4  
Blue LED



@ILLCLR8  
Intelligent switch

4

6 Decode area



@CADENA0  
Whole area decoding



@CADENA2  
Aiming area decoding

5

7 Good read vibration



@GRVENA1  
On



@GRVENA1  
Off

6

8 Terminating character suffix



@TSUSET0D  
Set terminating character to CR



@TSUSET0D0A  
Set terminating character to CRLF